

CONSTRUCTION: SS, CRS
 DIM TOL ±.25in
 ELECTRICAL REQUIREMENTS: 115VAC/1PH/60HZ/15A
 DRY WEIGHT: 275 LBS

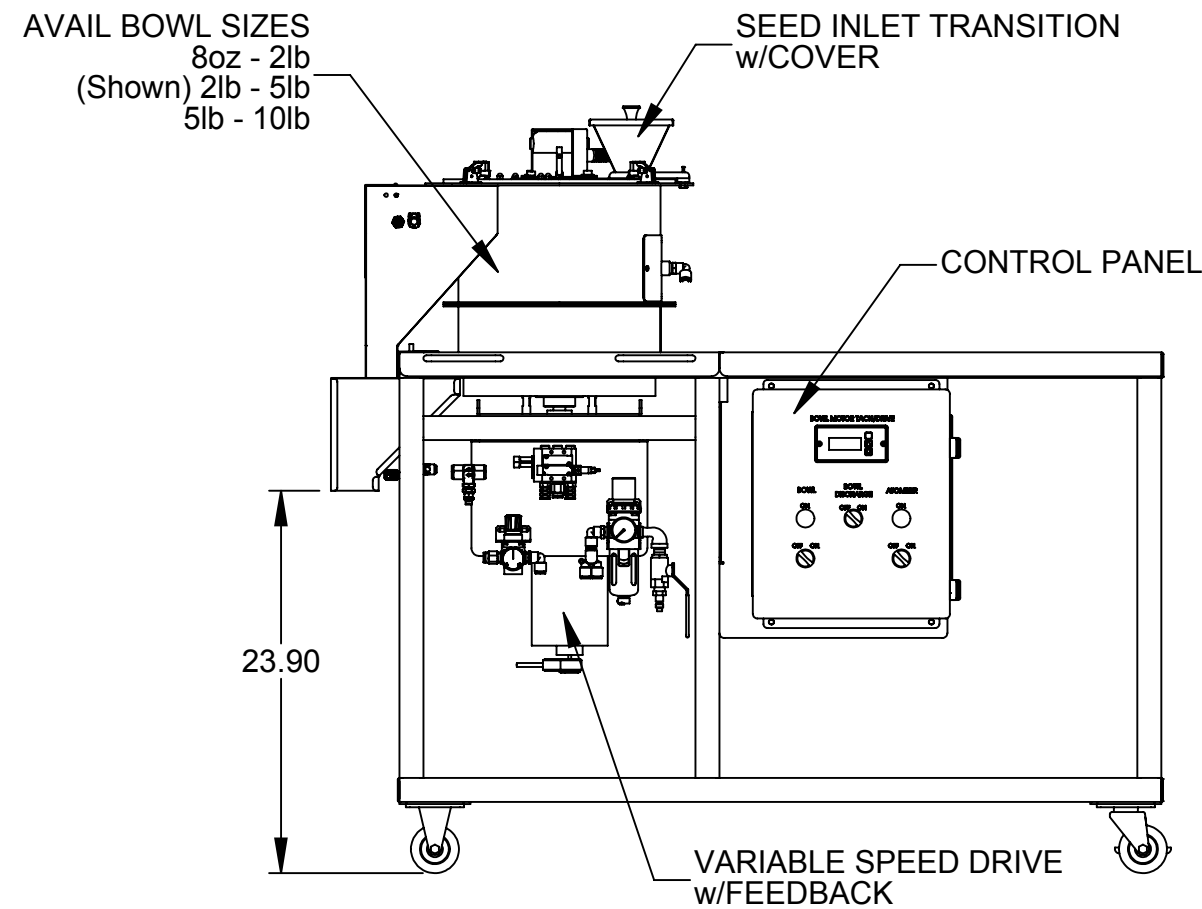

CUSTOMER
 PO#
 (-) UNIT REQ'D

ASSUMED SYMMETRY OF PARTS IS USED, UNLESS OTHERWISE DIMENSIONED	MFG. APPROVAL X	DATE X	DRAWN BY GAR	DATE 02/12/08
1 PLACE (X) ±.060" TOLERANCES- 2 PLACE (XX) ±.015" UNLESS OTHERWISE NOTED 3 PLACE (XXX) ±.005" FRACTIONS ±1/32" 4 PLACE (XXXX) ±.0005" ANGLES ±1/2°	SCALE 1:12	REDRAWN BY -	CHECKED BY GAR	DATE 02/12/08
TITLE BMC MANUAL - ALL OPTIONS			PART NUMBER A341 REF ONLY	
THIS DRAWING IS BAYER CROPSCIENCE PROPERTY FOR USE WITH GUSTAFSON EQUIPMENT ONLY. ALL DESIGN AND INVENTION RIGHTS.			REVISION -	

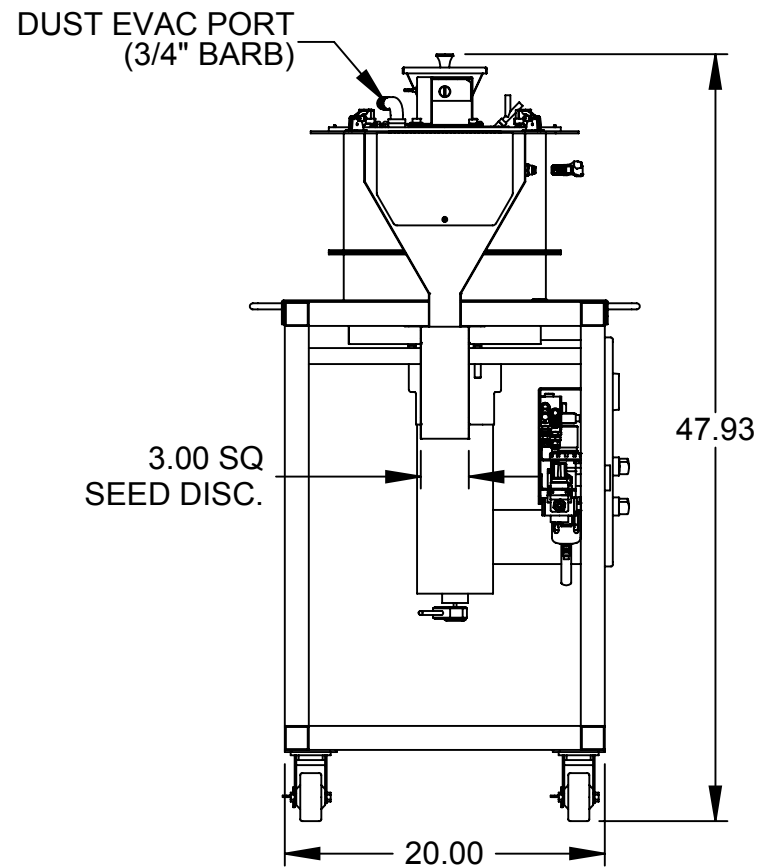
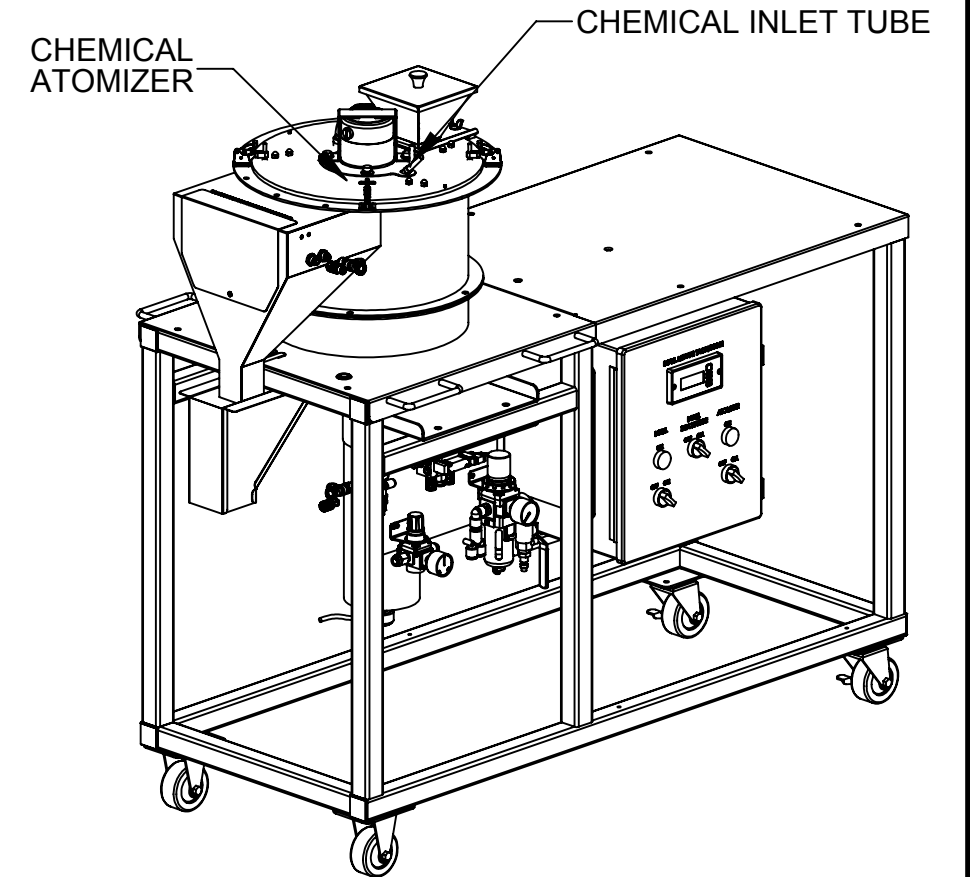
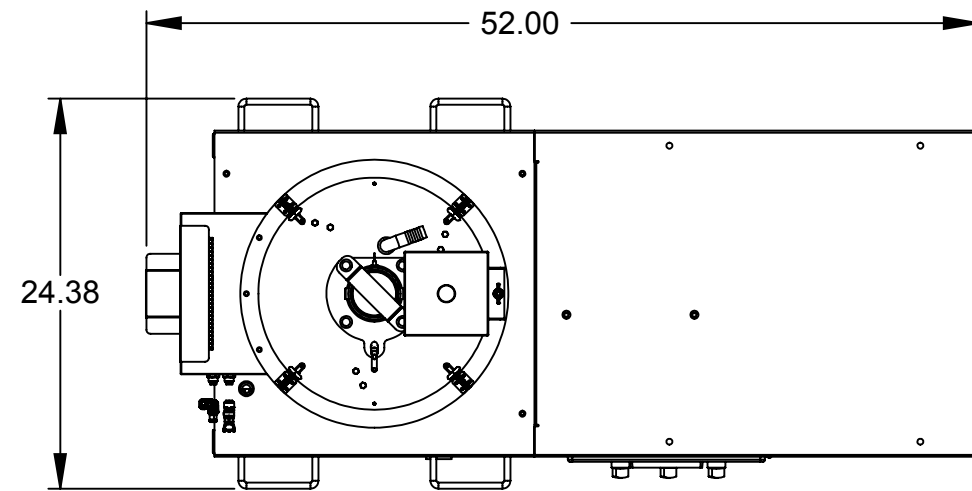

ITEM NO.	PART NUMBER	TITLE	QTY
1	A341500B	Batch Modular Coater .25/5 MANUAL	1
2	A341250A	SM. BODY ASSY - 8oz to 1.5lb (MAN)	1
3	A341350A	MED BODY ASSY - 1.5 to 5 lb (MAN)	1
4	A341450A	LRG BODY ASSY - 5 to 10 lb (MAN)	1

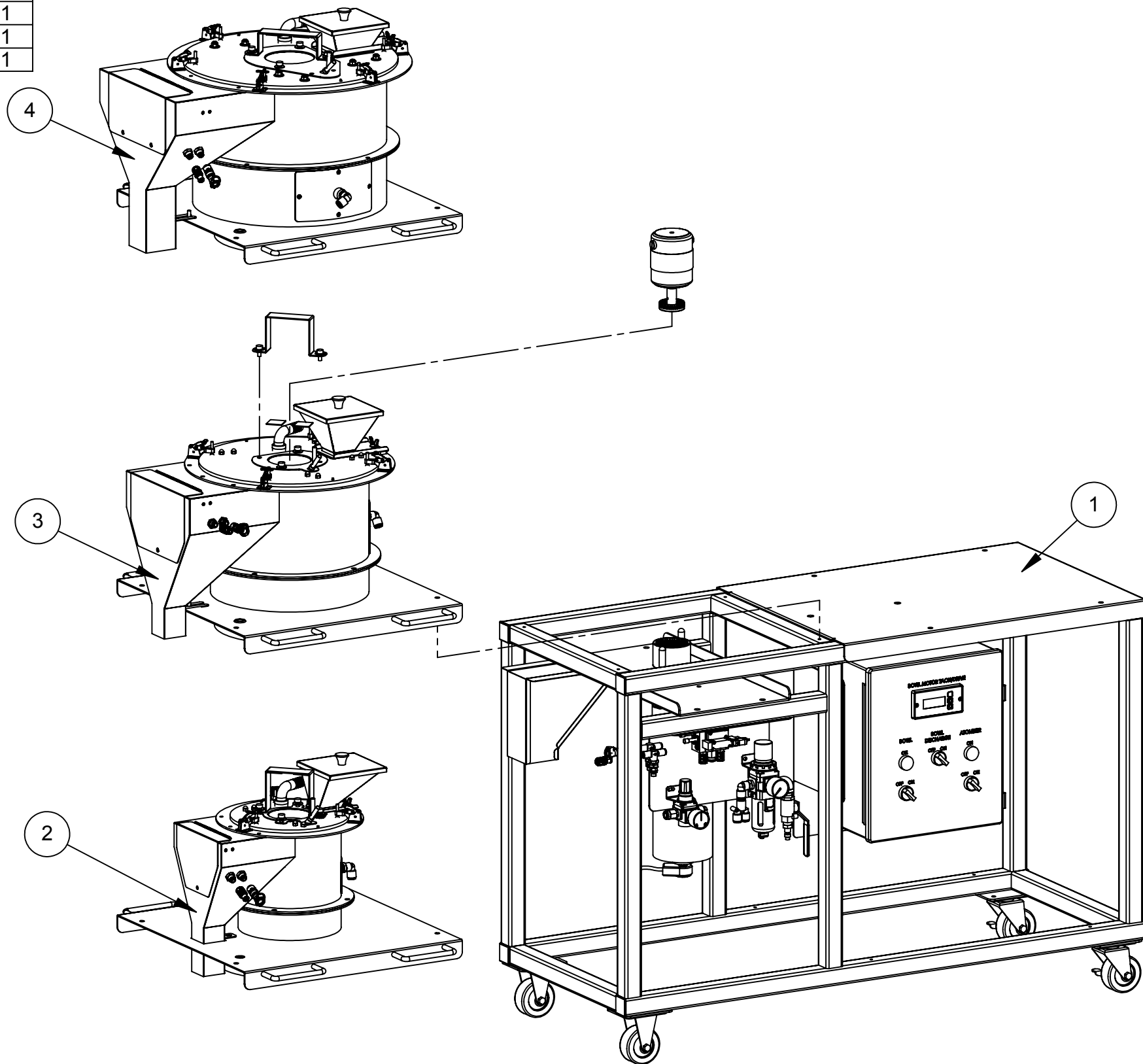

ASSUMED SYMMETRY OF PARTS IS USED, UNLESS OTHERWISE DIMENSIONED	
1 PLACE (X) = .060"	TOLERANCES- UNLESS OTHERWISE NOTED
2 PLACE (XX) = .015"	FRACTIONS ±1/32"
3 PLACE (XXX) = .005"	ANGLES ±1/2°
4 PLACE (XXXX) = .0005"	
THIS DRAWING IS BAYER CROPSCIENCE PROPERTY FOR USE WITH GUSTAFSON EQUIPMENT ONLY. ALL DESIGN AND INVENTION RIGHTS.	

MFG. APPROVAL X	DATE X	DRAWN BY GAR	DATE 02/12/08
SCALE 1:10		CHECKED BY GAR	DATE 02/12/08
TITLE BMC MANUAL - ALL OPTIONS		PART NUMBER A341 REF ONLY	

Gustafson

www.gustafson.com

REVISION
-